

Penthouse Duplex in Attard



Attard, Central



€795,000

Reference No: 240171006-2567

 Total Rooms: **8**

 Floor Area (m²) : **325**

 Bathrooms: **3**

 Bedrooms: **3**

Penthouse Duplex - For Sale - Attard

Presenting a unique chance to acquire this stunning corner duplex penthouse located in the sought-after area of Attard. Boasting a generous total area of 325 sqm, this exceptional property offers a perfect blend of space, style, and comfort. Step inside to find a welcoming entrance hall leading to a living area and a kitchen and breakfast area, ideal for contemporary living. This well-designed layout comprises a guest toilet, a main bathroom, and three bedrooms (the main bedroom with a shower en suite). The highlight of this magnificent property is its expansive private terrace, thoughtfully designed for outdoor living and entertainment. Enjoy: a good-sized private pool, BBQ area, and ample space for a bar or outdoor lounge setup. Perfect for entertaining guests or simply relaxing in style, this outdoor space is truly an extension of the living area. Flooded with natural light throughout, the penthouse is offered in shell form, allowing buyers the flexibility to customize the finishes to their own taste. A fully finished option is also available upon request. Additionally, an optional street-level 2 garage is available for purchase, providing further convenience.

Features

- ✓ Entrance Hall
- ✓ Pool
- ✓ Balcony
- ✓ Passenger Lift
- ✓ Terrace
- ✓ Pool Deck

Rooms

- ✓ Kitchen : 6 x 4.5 m (27 m²)
- ✓ Living : 6.5 x 4.5 m (29.25 m²)
- ✓ Double Bedroom : 3.3 x 5.7 m (18.81 m²)
- ✓ Double Bedroom : 3.3 x 3.2 m (10.56 m²)
- ✓ Double Bedroom : 5.8 x 3.2 m (18.56 m²)
- ✓ Shower Ensuite : 2 x 1.8 m (3.6 m²)
- ✓ Bathroom : 3 x 3 m (9 m²)
- ✓ Guest Toilet : 1.8 x 1.5 m (2.7 m²)
- ✓ Open Space : 7.2 x 2.2 m (15.84 m²)

Gallery







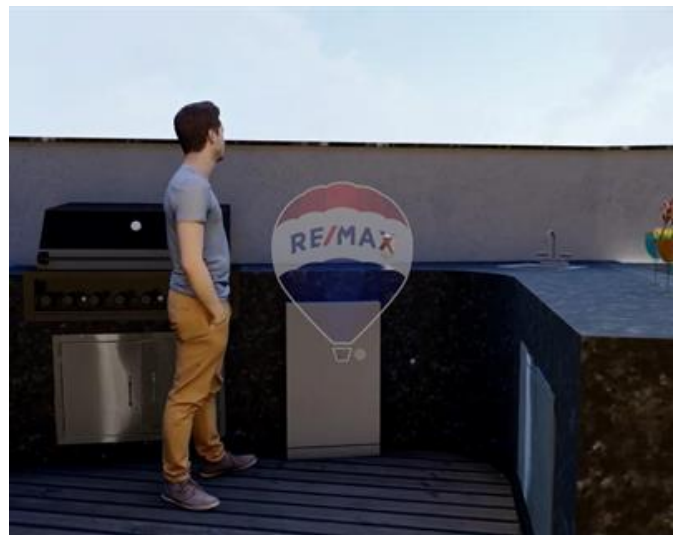
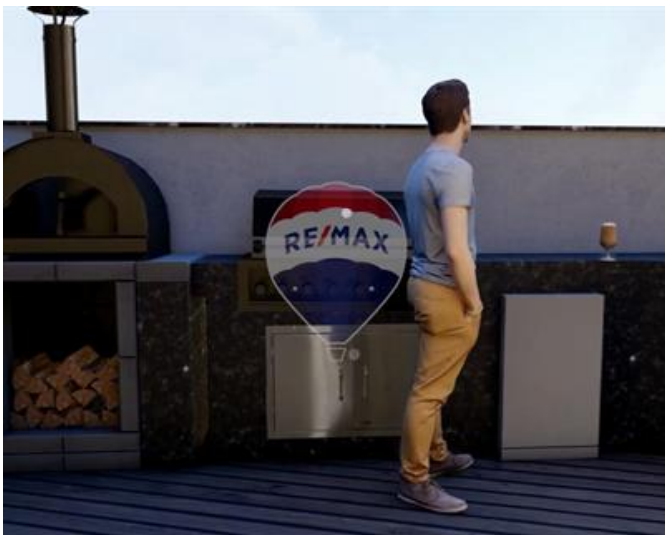

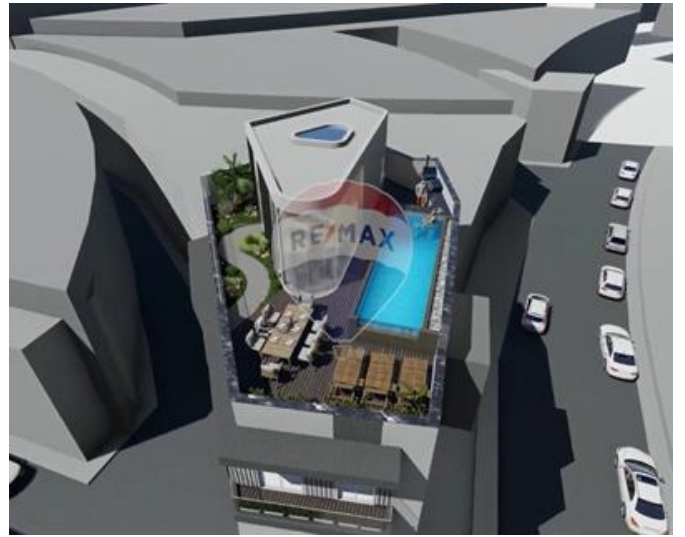



Anna Cirrincione

RE/MAX Luxe - Sliema

M: 99962506

E: acirrincione@remax.com.mt

T: 27992796

RE/MAX Luxe - Sliema

58, Tigne Seafront, Sliema, Malta