

# Townhouse in Zebbug



**Zebbug, Central**



**€1,275,000**

Reference No: 240271048-36

 Total Rooms: **12**

 Floor Area (m<sup>2</sup>) : **502**

 Bathrooms: **1**

 Bedrooms: **4**

# Townhouse - For Sale - Zebbug

ZEBBUG -A unique double-fronted residence comprising a spacious townhouse interconnected with a traditional farmhouse at the rear. The property features a grand lateral sitting and dining area, kitchen/dining, bathroom, internal yard with reservoir, and a six-car garage complemented by a workshop. The upper floor offers three generously sized bedrooms and a large roof terrace. The farmhouse, accessible through both the garage and the roof level, includes an impressive arched mill room, several substantial rooms, internal yards, a stable, and a wealth of original architectural features throughout. Rich in character and authentic charm, this one-of-a-kind property presents exceptional potential, ideal as a distinctive family home or for conversion into a boutique hotel.

## Features

- ✓ Ceramic Floor
- ✓ Back Yard
- ✓ Central Courtyard

## Rooms

- ✓ Double Bedroom : 3.23 x 4.53 m (14.63 m<sup>2</sup>)
- ✓ Living : 3.16 x 4.6 m (14.54 m<sup>2</sup>)
- ✓ Hallway : 4.8 x 1.83 m (8.78 m<sup>2</sup>)
- ✓ Hall : 1.24 x 5.31 m (6.58 m<sup>2</sup>)
- ✓ Dining : 3.2 x 4.86 m (15.55 m<sup>2</sup>)
- ✓ Kitchen : 2.47 x 3.78 m (9.34 m<sup>2</sup>)
- ✓ Open Space : 5.28 x 3.36 m (17.74 m<sup>2</sup>)
- ✓ Bathroom : 1.91 x 1.49 m (2.85 m<sup>2</sup>)
- ✓ Garage : 4.76 x 13.92 m (66.26 m<sup>2</sup>)
- ✓ Open Space : 5.28 x 3.36 m (17.74 m<sup>2</sup>)
- ✓ Twin Bedroom : 4.57 x 5.21 m (23.81 m<sup>2</sup>)
- ✓ Twin Bedroom : 3.43 x 4.55 m (15.61 m<sup>2</sup>)
- ✓ Box Room : 4.51 x 3.75 m (16.91 m<sup>2</sup>)
- ✓ Open Space : 3.4 x 5.23 m (17.78 m<sup>2</sup>)

- ✓ Open Space : 5.35 x 14.47 m (77.41 m<sup>2</sup>)
- ✓ Open Space : 3.76 x 2.92 m (10.98 m<sup>2</sup>)
- ✓ Open Space : 1.62 x 1.79 m (2.9 m<sup>2</sup>)
- ✓ Open Space : 6.35 x 4.86 m (30.86 m<sup>2</sup>)
- ✓ Open Space : 2.84 x 3.91 m (11.1 m<sup>2</sup>)
- ✓ Open Space : 3.22 x 1.8 m (5.8 m<sup>2</sup>)
- ✓ Open Space : 6.68 x 2.5 m (16.7 m<sup>2</sup>)
- ✓ Hallway : 2.6 x 12 m (31.2 m<sup>2</sup>)
- ✓ Open Space : 2.05 x 3.78 m (7.75 m<sup>2</sup>)
- ✓ Open Space : 6.75 x 3.38 m (22.81 m<sup>2</sup>)
- ✓ Cellar : 3.76 x 0.82 m (3.08 m<sup>2</sup>)
- ✓ Box Room : 8.91 x 2.45 m (21.83 m<sup>2</sup>)
- ✓ Twin Bedroom : 6.71 x 2.68 m (17.98 m<sup>2</sup>)
- ✓ Laundry : 4.81 x 3.77 m (18.13 m<sup>2</sup>)
- ✓ Open Space : 11.04 x 6.97 m (76.95 m<sup>2</sup>)
- ✓ Open Space : 7.19 x 3.48 m (25.02 m<sup>2</sup>)

# Gallery









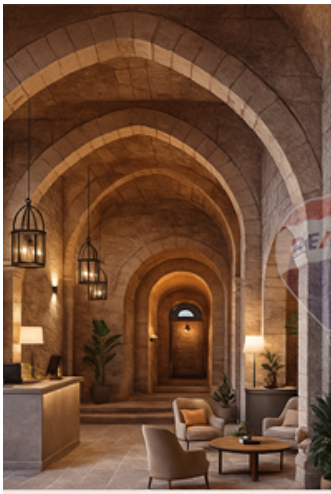

BOUTIQUE HOTEL LOBBY

ARTIST IMPRES

MODERN RESIDENCE LIVING ROOM



**Janica Schembri**

RE/MAX South - Marsascala

M: 79995454

E: [janicas@remax.com.mt](mailto:janicas@remax.com.mt)

T: 21555000

**RE/MAX South - Marsascala**

53, Triq is-Salini, Marsascala, Malta