

# Penthouse Duplex in Swieqi





Swieqi, Sliema and St Julians Surroundings



**€2,500**

Reference No: 240251128-405

 Total Rooms: **6**

 Floor Area (m<sup>2</sup>): **0**

 Bathrooms: **1**

 Bedrooms: **2**

# Penthouse Duplex - For Rent - Swieqi

Swieqi – A stunning two-bedroom, one bathroom duplex penthouse located in a highly sought-after area of Swieqi. This luxurious property boasts state-of-the-art furnishings and a spacious terrace, perfect for outdoor entertaining or relaxation. Situated close to a playground and local amenities, this penthouse offers the ideal blend of comfort, style, and convenience for modern living.

## Features

- ✓ Ceramic Floor
- ✓ A/C
- ✓ Balcony
- ✓ Electricity Utility
- ✓ Double Glazed

## Rooms

- ✓ Kitchen/Dining : 0 x 0 m (0 m2)
- ✓ Living : 0 x 0 m (0 m2)
- ✓ Double Bedroom : 0 x 0 m (0 m2)
- ✓ Double Bedroom : 0 x 0 m (0 m2)
- ✓ Laundry : 0 x 0 m (0 m2)
- ✓ Bathroom : 0 x 0 m (0 m2)

# Gallery



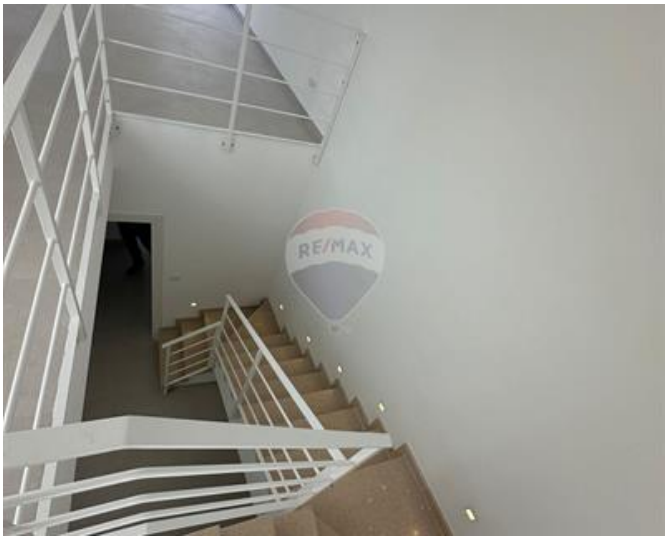



**Yanick Martin Schembri**

RE/MAX Advantage - Msida

M: 99333762

E: [yschembri@remax.com.mt](mailto:yschembri@remax.com.mt)

T: 21222123

**RE/MAX Advantage - Msida**

Regional Business Centre, Triq Achille Ferris, Msida, Malta