

Maisonette in San Pawl tat Targa

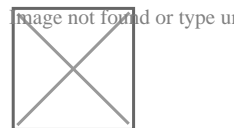



San Pawl tat Targa, Central



€1,500

Reference No: 240091056-2040

 Total Rooms: **6**

 Floor Area (m²) : **0**

 Bathrooms: **2**

 Bedrooms: **3**

Maisonette - For Rent - San Pawl tat Targa

SAN PAWL TAT TARGA - A new, highly finished elevated maisonette, set in this highly sought after villa area. The property comprises a front porch, a corridor, an open plan kitchen, living and dining leading onto a spacious 30 SqM back terrace, 3 double bedrooms (main with an en-suite walk-in shower room), a guest walk-in shower room, a box room and an internal yard. Complimenting this beautiful home is a garage which is included in the price. Highly recommended. Pet friendly.

Features

- ✓ Kitchen/Dinette
- ✓ Parquet Floor
- ✓ Electricity Utility
- ✓ Double Glazed
- ✓ Back Yard
- ✓ En Suite
- ✓ Water Utility
- ✓ A/C
- ✓ Central Courtyard
- ✓ Front Patio

Rooms

- ✓ Kitchen/Living/Dining : 0 x 0 m (0 m2)
- ✓ Double Bedroom : 0 x 0 m (0 m2)
- ✓ Double Bedroom : 0 x 0 m (0 m2)
- ✓ Double Bedroom : 0 x 0 m (0 m2)
- ✓ Shower : 0 x 0 m (0 m2)
- ✓ Shower Ensuite : 0 x 0 m (0 m2)

Gallery



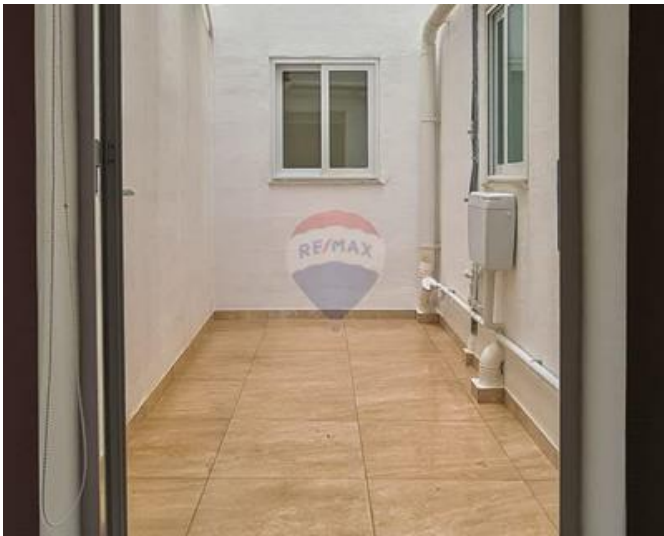





RE/MAX Crown - Sliema 1

RE/MAX Crown - Sliema

M: 99226499

E: crw@remax.com.mt

T: 21342410

RE/MAX Crown - Sliema

166, 169, Tower Road, Sliema, Malta